

# 磁力泵 マグネットポンプ

*New Series* 新产品

**TEO · TED · TEM**



***Magnetic  
Pump***

# General-propose small capacity magnetic pumps

小容量磁力泵

# TEO



## Features 特性

- Simple structure and long life.
- Resin bracket and pump base realizing light weight and high resistance to erosion.
- Two kinds of liquid-end material, GFR-PP and CFR-PVDF, the most suitable for transferring wide-range chemicals.
- Connections selectable from hose, thread, JIS10K flange 20A and 25A.
- 简单的构造, 长寿命
- 脚坐和底坐使用塑料, 锈不发生, 泵轻量
- 泵体的材质采用GFR-PP及CFR-PVDF
- 有3种连接方法, 软管·螺纹·法兰JIS10K 20A和25A

## Model code 型号意义

**TEO-180 PZ - T-R V 5 A**

① ② ③ ④ ⑤ ⑥ ⑦ ⑧ ⑨

① Series 系列代号	② Motor 马达	③ Material 材质	④ Head 扬程
TEO	180 180W 250 250W	P GFR-PP V CFR-PVDF	- 無 Standard 标准 Z High head 高扬程
⑤ Conection 连接方式		⑥ Bearing 轴承	⑦ O-ring O型圈
T Thread 螺纹	F20 JIS10K20A	R PTFE	V FKM
H Hose 软管	F25 JIS10K25A		E EPDM
⑧ Frequency 频率	⑨ Specific gravity Limt 对应比重		
5 50Hz	A 1.1	C 1.5	S Special 特别
6 60Hz	B 1.3	D 1.9	

※PVDF is nearly equal chemical resistance with PTFE(Teflon®). ※PVDF 有PTFE(Teflon®)同等的耐药品性。  
 ※Teflon® is trademark registration of DuPont USA. ※Teflon® 是杜邦(美国)公司的登记商标

## Dimensions 安装尺寸

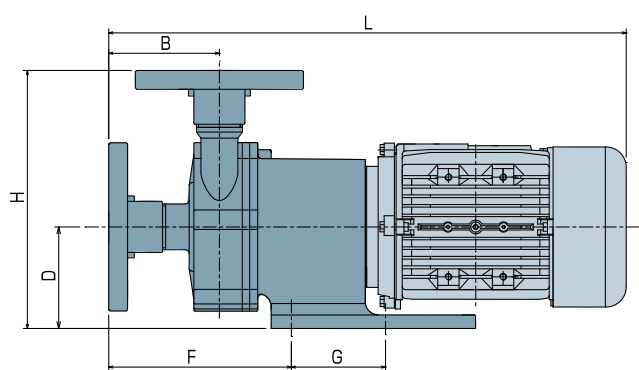
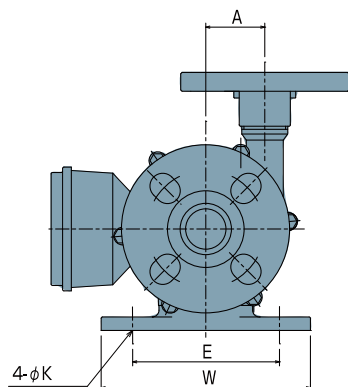

Model 型号	H	L	W	A	B	D	E	F	G	K	Weight (kg)
TEO - 180 - T	162	334	134	44	53	72	110	98	40	7	7
TEO - 180 - F	178	350	134	44	69	72	110	114	40	7	7
TEO - 250 - T	176	369	156	44	66	75	110	120	70	9	8
TEO - 250 - H	176	369	156	44	66	75	110	98	70	9	8
TEO - 250 - F	192	385	156	44	82	75	110	136	70	9	8
TEO - 180Z - T	175	320	134	48	42	72	110	86	40	7	7

※Dimension "L" is for Tomy standard motor installed.

※Please note that structure and dimension may change without prior notice, When designing, please request drawing and reconfirm.

※尺寸" L" 安装本公司标准电动机

※数据仅供参考, 使用电机不同. 等原因构造和外型尺寸会发生变化, 设计时请向索要正规图纸

## Standard Specifications 标准性能

Model 型号	Diameter(Suction × Discharge) 口径(入口 × 出口)			Head (m) 扬程 50/60Hz	Flow rate (L/min) 流量 50/60Hz	Motor (W) 马达
	Hose 软管	Thread 螺纹	Flange 法兰			
TEO-180P/V	26×26	G1"×G1"	20(25)×20(25)	6/8	60	180
TEO-250P/V	26×26	G1"×G1"	20(25)×20(25)	5.5/7.5	80	250
TEO-180PZ/VZ	20×20	G3/4"×G3/4"	—	12	20/30	180

\* Indication of minimum flow rate is approx.10% of maximum flow rate at 0m head.

\* 最少流量是最大流量的10%

## Material 构造

No.	Parts Name 部件名	Material 材质	
		TEO-P	TEO-V
①	Front Casing 泵壳	GFR- PP	CFR-PVDF
②	Impeller 叶轮组	GFR- PP	CFR-PVDF
③	Bearing 轴承	PTFE	
④	Rear Casing 隔离套	GFR- PP	CFR-PVDF
⑤	Shaft 泵轴	Alumina Ceramics 氧化铝陶瓷	Alumina Ceramics 氧化铝陶瓷
⑥	Front thrust 前止推环	Alumina Ceramics 氧化铝陶瓷	Alumina Ceramics 氧化铝陶瓷
⑦	Rear thrust 后止推环	Alumina Ceramics 氧化铝陶瓷	Alumina Ceramics 氧化铝陶瓷
⑧	O-ring O型圈	FKM/EPDM	
⑨	Bracket 底座	GFR- PP	
⑩	Base 脚坐	GFR- PP	

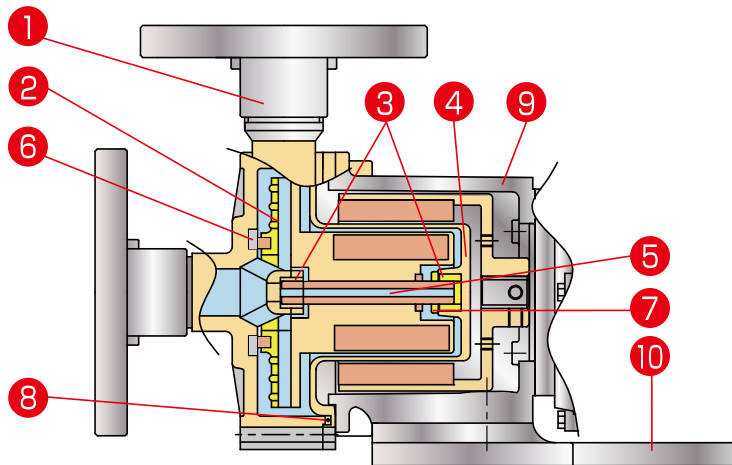

## Performance curve 性能曲线

■ 50Hz

Head 全扬程 [m]

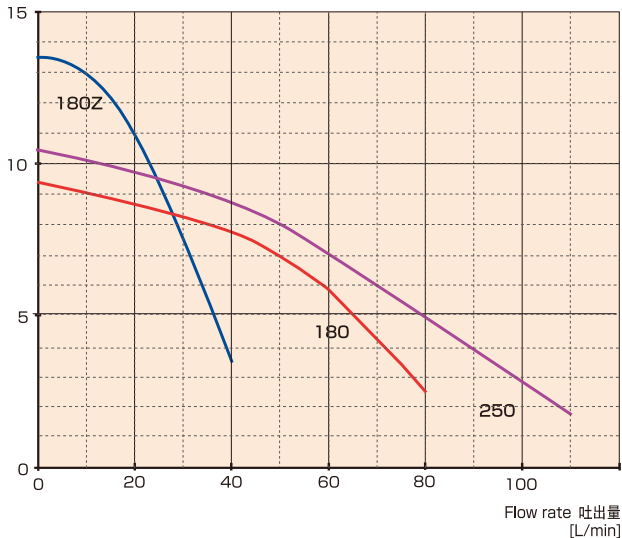

■ 60Hz

Head 全扬程 [m]

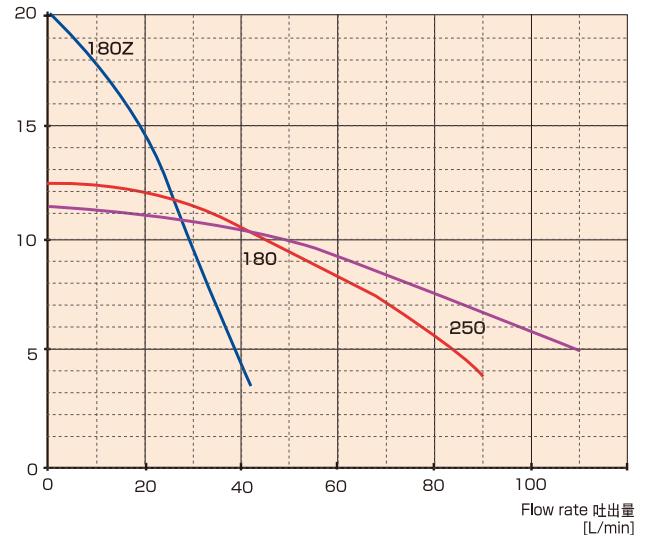

# General-propose medium capacity magnetic pumps

中容量磁力泵

# TED



## Features 特性

- The pumps more than 0.75kW use a Neodymium magnet, Small size light weight magnet can.
- New development impeller, One structure By molding impeller and shroud one, The balance of the impeller improved. Minimized vibration.
- All model resin bracket and pump base. Bracket and pump base made by resin superior in corrosion resistance.
- 这个泵0.75kW（一马力）以上全机种采用钕磁铁（超强有力磁铁），叶轮小型轻量
- 脚坐和底坐使用塑料，锈不发生，泵轻量
- 新设计叶轮，一体的构造 叶轮平衡极好，震荡非常少

## Model code 型号意义

TED - 400 P - R V 5 A

① ② ③ ④ ⑤ ⑥ ⑦

① Bore 吐出口径		② Motor 马达		③ Material 材质			
40	40A	0	0.4kw	3	2.2kw	P	GFR-PP
50	50A	1	0.75kw	5	3.7kw	F	CFR-ETFE
		2	1.5kw				

④ Bearing 轴承		⑤ O-ring O型圈		⑥ Frequency 频率		⑦ Specific gravity Limt 对应比重	
R	PTFE	V	FKM	5	50Hz	A	1.1 D 1.9
		E	EPDM	6	60Hz	B	1.3 S Special 特别
		S	Special 特别			C	1.5

※ETFE is nearly equal chemical resistance with PTFE(Teflon®). ※ETFE 有PTFE(Teflon®)同等的耐药品性.  
 ※Teflon® is trademark registration of DuPont USA. ※Teflon® 是杜邦(美国)公司的登记商标

## Dimensions 安装尺寸

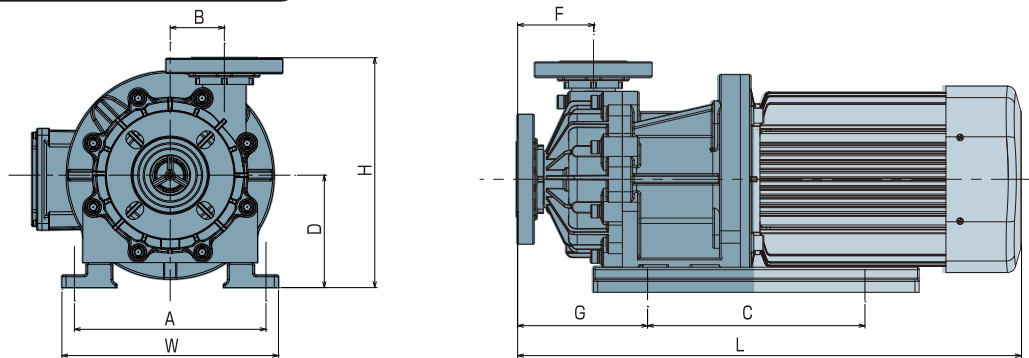

Model 型号	W	H	L	A	B	C	D	F	G	Weight(kg)
TED - 400	140	216	438	110	51	98	95	87	150	10.5
TED - 401	160	254	485	130	57.5	130	115	103	185(175)	15
TED - 402	260	255	505	208	65	200	115	89	158	20
TED - 403	260	255	530	208	65	200	115	89	158	23
TED - 405	260	275(270)	603	230	65	260	135(130)	89	158	38
TED - 505	260	298	616	230	65	260	135	110	175	41

※Dimension "L" is for Tomy standard motor installed.  
 ※Please note that structure and dimension may change without prior notice, When designing, please request drawing and reconfirm.  
 ※尺寸" L " 安装本公司标准电动机  
 ※数据仅供参考, 使用电机不同, 等原因构造和外型尺寸会发生变化, 设计时请向索要正规图纸

## Standard Specifications 标准性能

Model 型号	(Suc.×Dis) (入口×出口)	Head 扬程 (m) 50/60Hz	Flow rate 流量(L/min)50/60Hz	Motor (kW) 马达
TED-400P/F	40A×40A	7.5/8	150	0.4
TED-401P/F	40A×40A	11/12	200	0.75
TED-402P/F	50A×40A	15	300	1.5
TED-403P/F	50A×40A	18	360	2.2
TED-405P/F	50A×40A	26	400	3.7
TED-505P/F	65A×50A	19/20	600	3.7

\* Indication of minimum flow rate is approx.10% of maximum flow rate at 0m head.

\* 最少流量是最大流量的10%

## Material 构造

No.	Parts Name 部件名	Material 材质	
		TED-P	TED-F
①	Front Casing 泵壳	GFR-PP	CFR-ETFE
②	Impeller 叶轮组	GFR-PP	CFR-ETFE
③	Mouth ring 磨损环	PTFE	
④	Bearing 轴承	PTFE	
⑤	Rear Casing 隔离套	GFR-PP	CFR-ETFE
⑥	Shaft 泵轴	Alumina Ceramic 氧化铝陶瓷 / SiC	Alumina Ceramic 氧化铝陶瓷 / SiC
⑦	Front thrust 前止推环	Alumina Ceramic 氧化铝陶瓷 / SiC	Alumina Ceramic 氧化铝陶瓷 / SiC
⑧	Rear thrust 后止推环	Alumina Ceramic 氧化铝陶瓷 / SiC	Alumina Ceramic 氧化铝陶瓷 / SiC
⑨	O-Ring O型圈	FKM / EPDM	
⑩	Bracket 底座	GFR-PP	
⑪	Drive Magnet 驱动磁铁	Ferrite / Neodymium 铁氧体磁铁 / 钕磁铁	

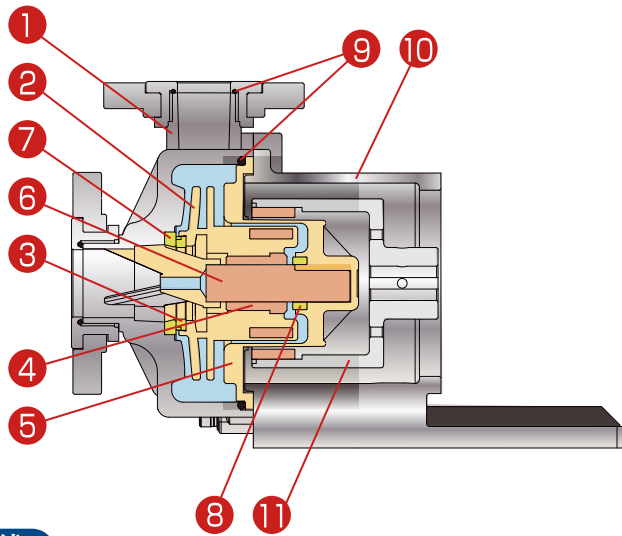

## Performance curve 性能曲线

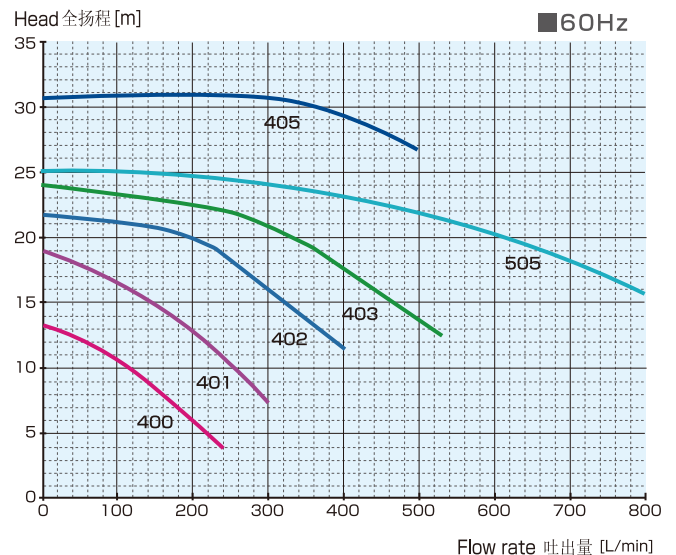
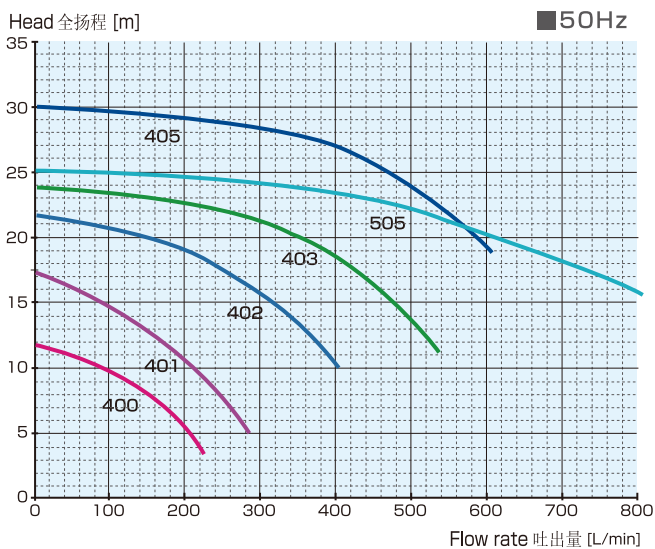

# General-purpose medium capacity magnetic pumps

中容量磁力泵

# TEM



## Features 特性

- The pumps more than 0.75kW use a Neodymium magnet, Small size light weight magnet can.
- All model resin bracket. Bracket and pump base made by resin superior in corrosion resistance.
- 这个泵0.75kW（一马力）以上全机种采用钕磁铁（超强有力磁铁），叶轮小型轻量
- 脚坐使用塑料，锈不发生，泵轻量

## Model code 型号意义

TEM - 44 0 P - C V 5 A

① ② ③      ④ ⑤ ⑥ ⑦

### ① Bore 口径

2	25A	5	50A
4	40A	6	65A

### ② Motor 马达

0	0.4kw	3	2.2kw
1	0.75kw	5	3.7kw
2	1.5kw		

### ③ Material 材质

P	GFR-PP
F	CFR-ETFE

### ④ Bearing 轴承

C	Carbon
R	PTFE
A	Alumina Ceramic
S	SiC

### ⑤ O-ring O型圈

V	FKM
E	EPDM
S	Special 特别

### ⑥ Frequency 频率

5	50Hz
6	60Hz

### ⑦ Specific gravity Limt 对应比重

A	1.1	D	1.9
B	1.3	H	1.0
C	1.5	S	Special 特别

※ETFE is nearly equal chemical resistance with PTFE(Teflon®).

※Teflon® is trademark registration of DuPont USA.

※ETFE 有PTFE(Teflon®)同等的耐药品性.

※Teflon® 是杜邦(美国)公司的登记商标

## Dimensions 安装尺寸

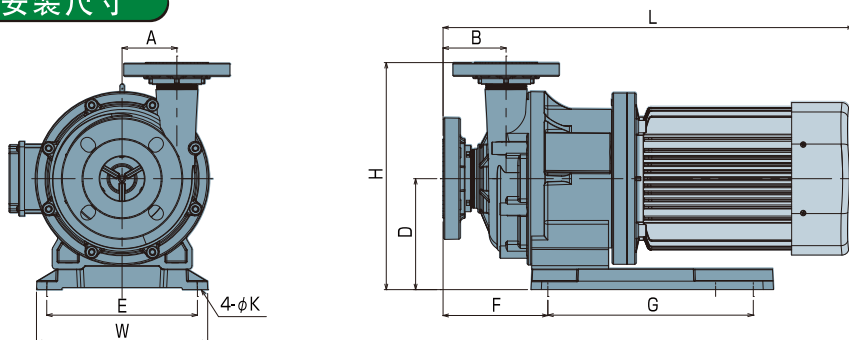

Model 型号	W	H	L	E	A	G	D	B	F	K	Weight (kg)
TEM-220	160	255	449	130	65	130	115	90	171	12	10.5
TEM-221	160	255	479	130	65	130	115	90	171	12	17
TEM-440	140	225	444	110	54	98	95	87	150	12	10.5
TEM-441	160	257	489	130	72	130	115	105	187	12	17
TEM-542	260	280	500	204	80	200	120	90	159	14	23
TEM-543	260	280	525	204	80	200	120	90	159	14	26
TEM-545	250	322	593	220	80	300	162	90	153	14	40
TEM-655	250	331	600	220	80	300	162	92	153	14	40

※Dimension "L" is for Tomy standard motor installed.

※Please note that structure and dimension may change without prior notice. When designing, please request drawing and reconfirm.

※尺寸" L " 安装本公司标准电动机

※数据仅供参考, 使用电机不同, 等原因构造和外型尺寸会发生变化, 设计时请向索要正规图纸

## Standard Specifications 标准性能

Model 型号	(Suc.xDis) (入口×出口)	Head 扬程 (m) 50/60Hz	Flow rate 流量 (L/min) 50/60Hz	Motor (kW) 马达
TEM-220P/F	25A×25A	13/12	60	0.4
TEM-221P/F	25A×25A	17/20	80	0.75
TEM-440P/F	40A×40A	9	150	0.4
TEM-441P/F	40A×40A	13	150	0.75
TEM-542P/F	50A×40A	18	210	1.5
TEM-542H-P/F	50A×40A	26/29	100	1.5
TEM-543P/F	50A×40A	22	300	2.2
TEM-543H-P/F	50A×40A	33	150	2.2
TEM-545P/F	50A×40A	30/34	280	3.7
TEM-655P/F	65A×50A	20/18	600	3.7

## Material 构造

No.	Parts Name 部件名	Material 材质	
		TEM-P	TEM-F
①	Front Casing 泵壳	GFR-PP	CFR-ETFE
②	Impeller 叶轮组	GFR-PP	CFR-ETFE
③	Mouth ring 磨损环	PTFE / SiC	
④	Bearing 轴承	Carbon / PTFE / Alumina Ceramic / SiC	炭精 / PTFE / 氧化铝陶瓷 / SiC
⑤	Rear Casing 隔离套	GFR-PP	CFR-ETFE
⑥	Shaft 泵轴	Alumina Ceramic	氧化铝陶瓷 / SiC
⑦	Front thrust 前止推环	Alumina Ceramic	氧化铝陶瓷 / SiC
⑧	Rear thrust 后止推环	Alumina Ceramic	氧化铝陶瓷 / SiC
⑨	O-Ring O型圈	FKM / EPDM	
⑩	Bracket 底座	GFR-PP	
⑪	Base 脚坐	GFR-PP / SUS304	
⑫	Drive Magnet 驱动磁铁	Ferrite / Neodymium	铁氧体磁铁 / 钕磁铁

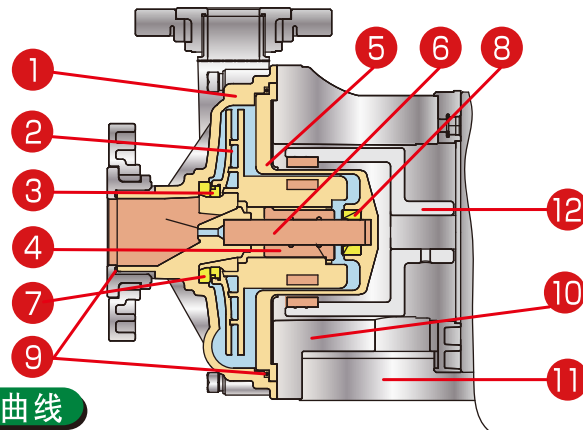

## Performance curve 性能曲线

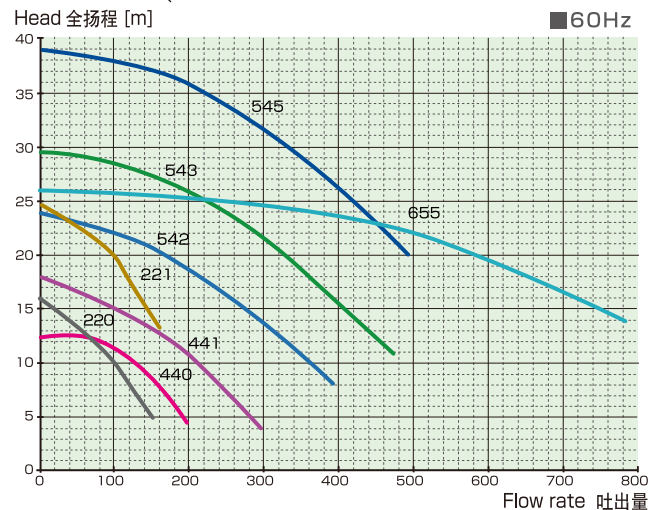
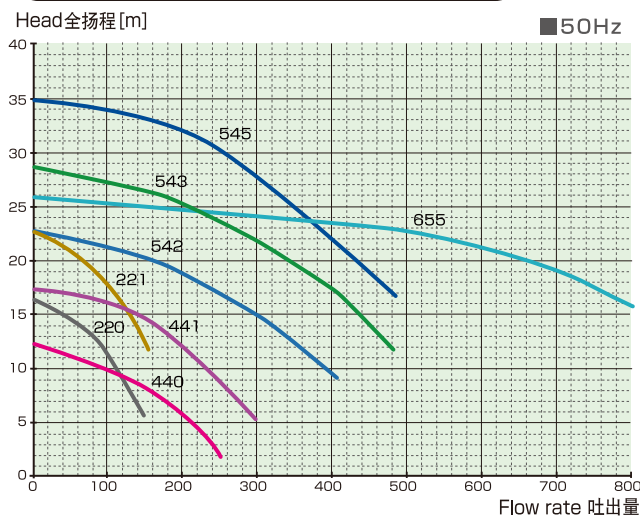



TOMY ENG Corp.

トミエンジ株式会社  
TOMYENG Corp.

Address 1-19-2 Taito Taito-ku  
Tokyo 110-0016 JAPAN  
TEL.03-6806-0320 FAX.03-6736-0284

地 址 日本国台東区台東1-19-2  
TEL.03-6806-0320 FAX.03-6736-0284

Home Page <http://www.tomyeng.co.jp>

